



**4 Belgravia Terrace, Fore Street**  
Kingswear  
Offers in the region of £215,000

*Freeborns*  
ESTATE AGENTS

A well presented and centrally located apartment benefiting from panoramic views of the River Dart and communal gardens suited to alfresco dining.

SOLD CHAIN FREE.





# 4 Belgravia Terrace, Fore Street, Kingswear, TQ6 0AQ

## THE ACCOMMODATION COMPRISES:

(ALL MEASUREMENTS APPROX)

### ENTRANCE HALL

Well mounted cupboard housing fuse box and electric metre, night storage heater, doors to;

### OPEN PLAN KITCHEN/LIVING ROOM

Double glazed window to front with views across the Kingswear harbour, the River Dart and towards Dartmouth, night storage heater.

### KITCHEN AREA

Range of base and wall mounted cupboards and draws, worksurface with inset single drainer stainless steel sink, inset four ring electric hob, built-in electric oven under and extractor fan above, integrated fridge.

### BEDROOM

Window to side, night storage heater.

### BATHROOM

Double glazed frosted window to rear, panelled bath with 'mira go' electric shower over, pedestal wash hand basin, close coupled WC, part tiled walls, extractor fan, wall mounted electric fan heater, built-in airing cupboard housing hot water cylinder.

### GARDEN

Terraced communal rear garden with decking overlooking the River Dart.

### LOCAL AUTHORITY

South Hams District Council

### COUNCIL TAX BAND: B

### SERVICE CHARGE

£76.01pcm

### EPC: E

### CONSUMER PROTECTION FROM UNFAIR TRADING

These details are for guidance only and complete accuracy cannot be guaranteed. If there is any point, which is of particular importance,

verification should be obtained. They do not constitute a contract or part of a contract. All measurements are approximate. No guarantee can be given with regards to planning permissions or fitness for purpose. No apparatus, equipment, fixture or fitting has been tested. Items shown in photographs are NOT necessarily included. Interested parties are advised to check availability and make an appointment to view before travelling to see a property.

## 4 Belgravia Terrace, Kingswear

Approximate Gross Internal Area  
484 sq ft - 45 sq m

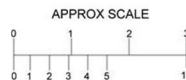
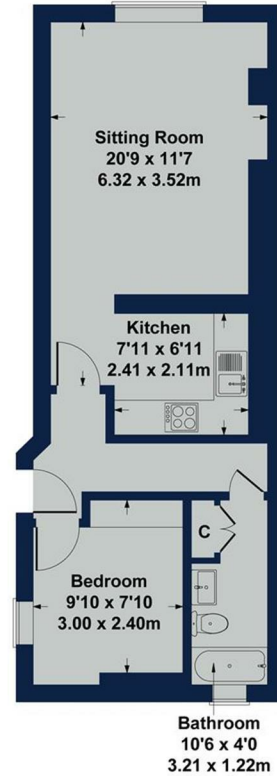

SKETCH PLAN FOR ILLUSTRATIVE PURPOSES ONLY  
Produced by The Plan Portal/Potterplans Ltd. 2025



1 Mayors Avenue, Dartmouth, Devon, TQ6 9NF

Tel: 01803 832 045

info@freebornsproperty.co.uk

www.freebornsproperty.co.uk

**Freeborns**  
ESTATE AGENTS

